

Day	Date	Work Area	Roadway	Lane/Shoulder	Start	Finish	Work to Be Completed
-----	------	-----------	---------	---------------	-------	--------	----------------------

Section 5 Townships of Robbinsville & East Windsor, Mercer County

Traffic slowdowns and short term road closures are subject to "weather permitting"



Section 5 - Notice of Local Road Closure and Detour



Windsor Road NJT Bridge, Township of Robbinsville, Mercer County, is now **OPEN**.

It is anticipated that **Sharon Road bridge** over the NJ Turnpike in the Township of Robbinsville, Mercer County will be **closed** on or about **February 6, 2012**. Sharon Road bridge is anticipated to be closed for a period of 18 months for a bridge replacement. A detour utilizing Old York Road and Gordon Road will then be in place. Please see detour map for more information.

It is anticipated that the **Perrineville Road bridge** over the NJ Turnpike in the Townships of Robbinsville & East Windsor, Mercer County, will be **closed** on or about **March 12, 2012** for a bridge replacement. A detour utilizing Old York Road, Sharon Road and Windsor Road will be in place. Please see detour map for more information.

MO	2/6/2012	Section 5, NJ Turnpike Milepost 64.1 - 62.7	Southbound	Right/Center Lanes	11:59 PM	5:00 AM	Conduit (asbestos) removal Str. 62.86
TU	2/7/2012	Section 5, NJ Turnpike Milepost 61.3 - 63.0	Northbound	Right/Center Lanes	11:00 PM	4:00 AM	Conduit (asbestos) removal Str. 62.86
WE	2/8/2012	Section 5, NJ Turnpike Milepost 64.1 - 62.7	Southbound	Left/Center Lanes	11:00 PM	5:00 AM	Conduit (asbestos) removal Str. 62.86
TH	2/9/2012	Section 5, NJ Turnpike Milepost 61.3 - 63.0	Northbound	Left/Center Lanes	11:00 PM	4:00 AM	Conduit (asbestos) removal Str. 62.86

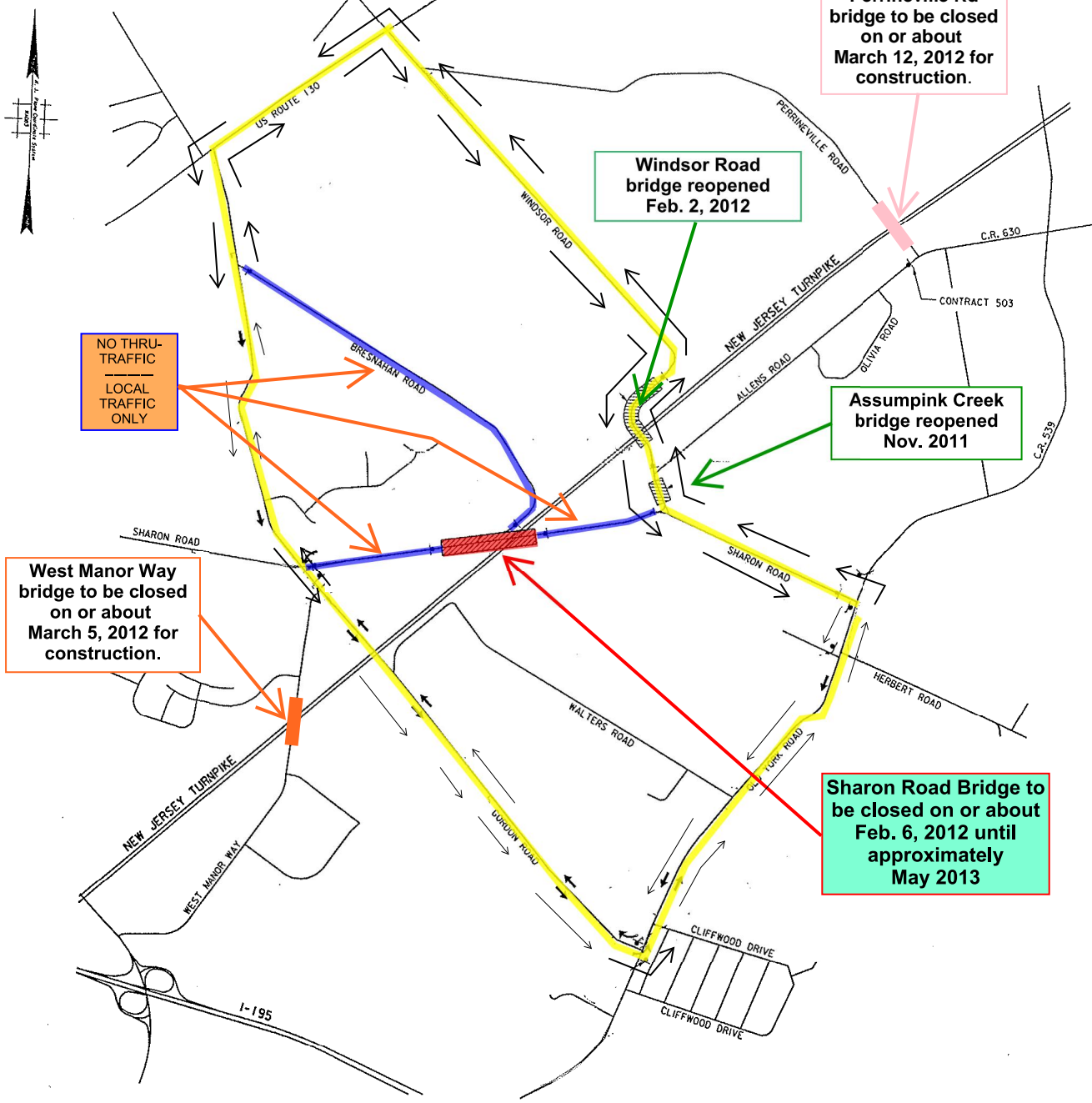

Sharon Road Bridge Closure Information:

Effective on or about Feb. 6, 2012, the Sharon Road Bridge over the NJ Turnpike will be closed for a period of approximately 18 months for construction.

Motorists can use Windsor and Gordon Roads from Sharon Road to access points north and south.

The detour route for Sharon Road will be signed and will utilize Gordon Road, Windsor Road, Old York Road and State Route 130. Local traffic only will be allowed on Bresnahan Road and on Sharon Road adjacent to the work zone.





Perrineville Rd bridge closed for construction.

CR- 630 Perrineville Road

East Windsor Township

Windsor Road bridge reopened Feb. 2, 2012

**NO THRU-TRAFFIC
LOCAL TRAFFIC ONLY**

CR- 630 Perrineville Road

Sharon Road Bridge to be closed on or about Feb. 6, 2012 until approximately May 2013

Robbinsville Township

Perrineville Road Detour Route

Local Traffic Only (No Thru-Traffic)

Work Zone

Perrineville Road Detour
Effective on or about March 12, 2012, the Perrineville Road bridge over the NJ Turnpike will be closed for construction.
The detour route for Perrineville Road will be signed and motorists will utilize Windsor, Sharon and Old York Roads. Local traffic only will be allowed on Allens and Perrineville Roads adjacent to the work zone.

