

## CONSTRUCTION ACTIVITY NOTICE

### To Robbinsville Township Residents

Please be advised that as part of the NJ Turnpike Widening Program, the Sharon Road Bridge over the New Jersey Turnpike will be demolished and reconstructed. Starting on or about February 1, 2012, Sharon Road will be closed to traffic between Bresnahan Road and Windsor Road for approximately 18 months. Additionally, Bresnahan Road will be closed to through traffic at Sharon Road. A detour will be in place to guide traffic around the closed portion of Sharon Road (local access to the closed portions of Sharon Road will be maintained for residents at all time) utilizing the open portions of Sharon Road, Windsor Road, Old York Road, Gordon Road and State Route 130.

The NJ Turnpike Authority apologizes for any inconvenience. If you have any questions or require additional information, please visit the 6 to 9 Widening website at [www.njturnpikewidening.com](http://www.njturnpikewidening.com) or call the Widening Program toll free question line 1-877-NJT-WIDE (1-877-658-9433).

Project: NJT Interchange 6 to 9 Widening Program  
CONTRACT # T869.120.502  
NJ Turnpike Mileposts 62.0 to 63.4  
Township of Robbinsville , Mercer County, NJ

Work Location: Sharon Road Bridge over the NJ Turnpike

Work Dates & Hours: Starting on or about February 1, 2012

Anticipated completion: On or about May 1, 2013

Construction Activities: Demolition & replacement of the existing Sharon Road Bridge and related construction activities.

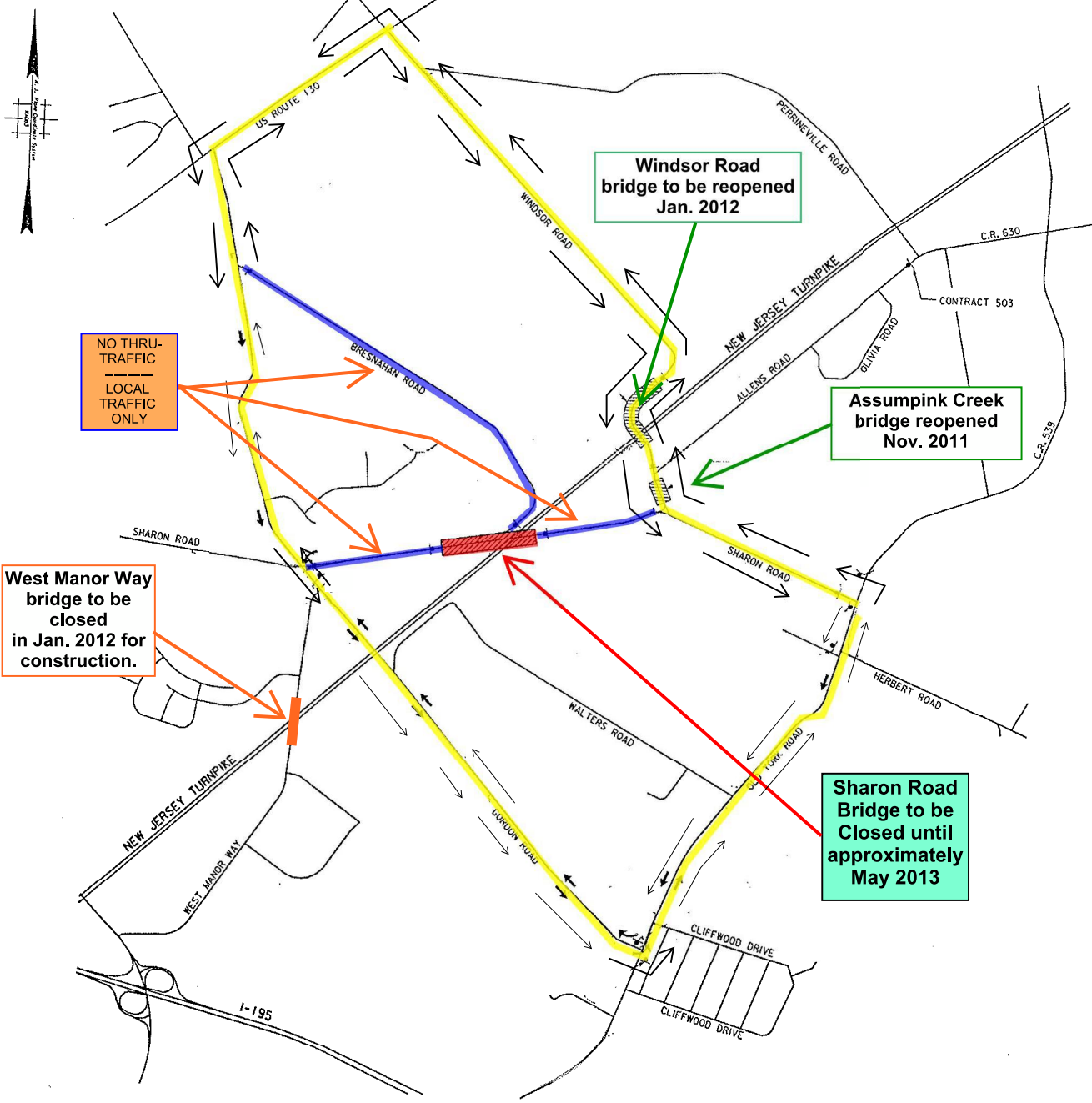

**Sharon Road Detour Route**



**Local Traffic Only (No Thru-Traffic)**



**Work Zone**



Effective on or about February 1, 2012, the Sharon Road Bridge over the NJ Turnpike will be closed for a period of approximately 18 months for construction.

Motorists can use Windsor and Gordon Roads from Sharon Road to access points north and south.

The detour route for Sharon Road will be signed and will utilize Gordon Road, Windsor Road, Old York Road and State Route 130. Local traffic only will be allowed on Bresnahan Road and on Sharon Road adjacent to the work zone.

